

HOW TO MAKE A SIMPLE BOOK

PREPARING THE TEXT BLOCK:

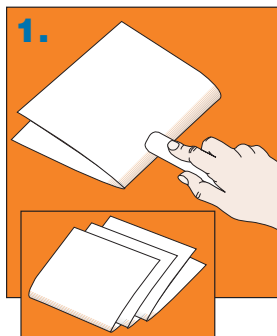

1. Sheets of paper are folded with a bone folder and interleaved to make a signature.

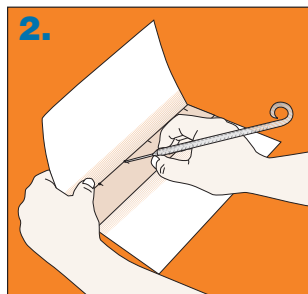

2. Guided by marks on a stiff paper, an awl is used to punch holes in each signature.

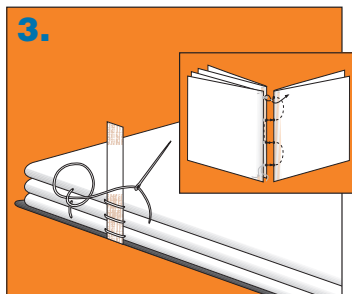

3. A signature is sewn to binding tape. Additional signatures are added and sewn in turn. An end sheet of strong paper is sewn or tipped on using glue. Marbled or other decorative paper may be laminated to the end sheet.

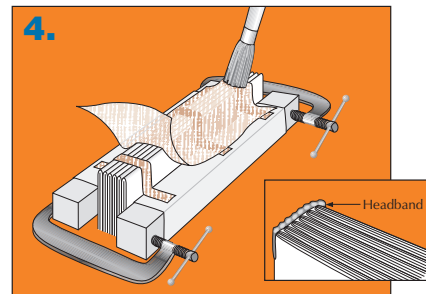

4. The text block is compressed with a clamp. Open weave cloth, called super, is laid on the spine and a coat of neutral pH adhesive is brushed through the super to form a flexible yet strong bond when dry. A decorative headband may be glued to the ends of the text block.

PREPARING THE COVER:

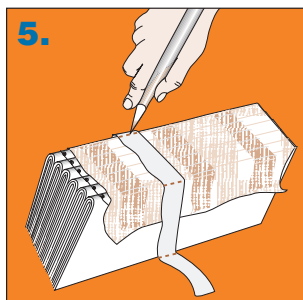

5. Width dimensions for the cover and spine strip are captured from the text block by wrapping a strip of paper around the spine and marking the spine width and cover size.

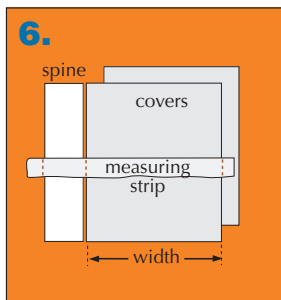

6. Covers are cut from heavy duty (.060"-.100") binder's board. The spine piece is cut from acid-free stock .010"-.012" thick.

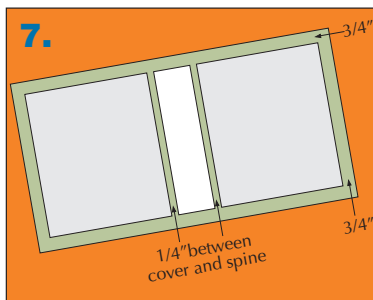

7. Covers and the spine piece are laid on book cloth and the cloth is cut 3/4" larger on all sides. Neutral pH adhesive is spread on the inside surface of the book cloth and the three pieces are positioned, pressed to remove air and allowed to dry.

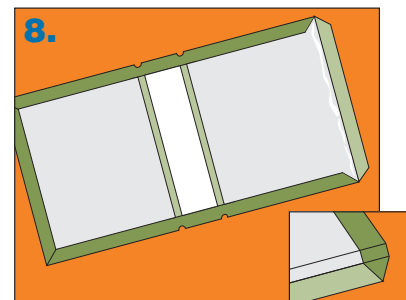

8. The overhanging book cloth is turned over the covers and spine and glued down with neutral pH adhesive. Corners are mitred using a "bedsheet" tuck.

FINAL ASSEMBLY PROCESS:

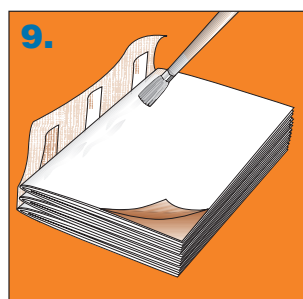

9. Neutral pH adhesive is applied to the super and binding tape to bond these to the end sheet.

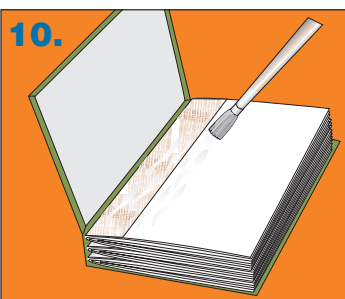

10. The text block is placed on the inside of the cover blank. The end sheet is glued to the cover. Finally, the book is pressed or clamped between boards and let dry.

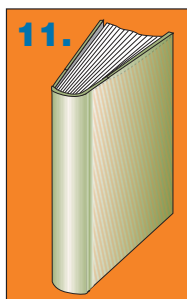

11. Finished book

LINECO®

Lineco, Inc.

517 Main Street, P.O. Box 2604

Holyoke, MA 01041-2604

PH: 800-322-7775

FAX: 800-298-7815

Email: info@lineco.com